

EXP-10AL

REVISION: B
ECO NO.: 2270
BY: G. REEDER
DATE: 3/20/06

COXREELS SERIES P - ALUMINUM

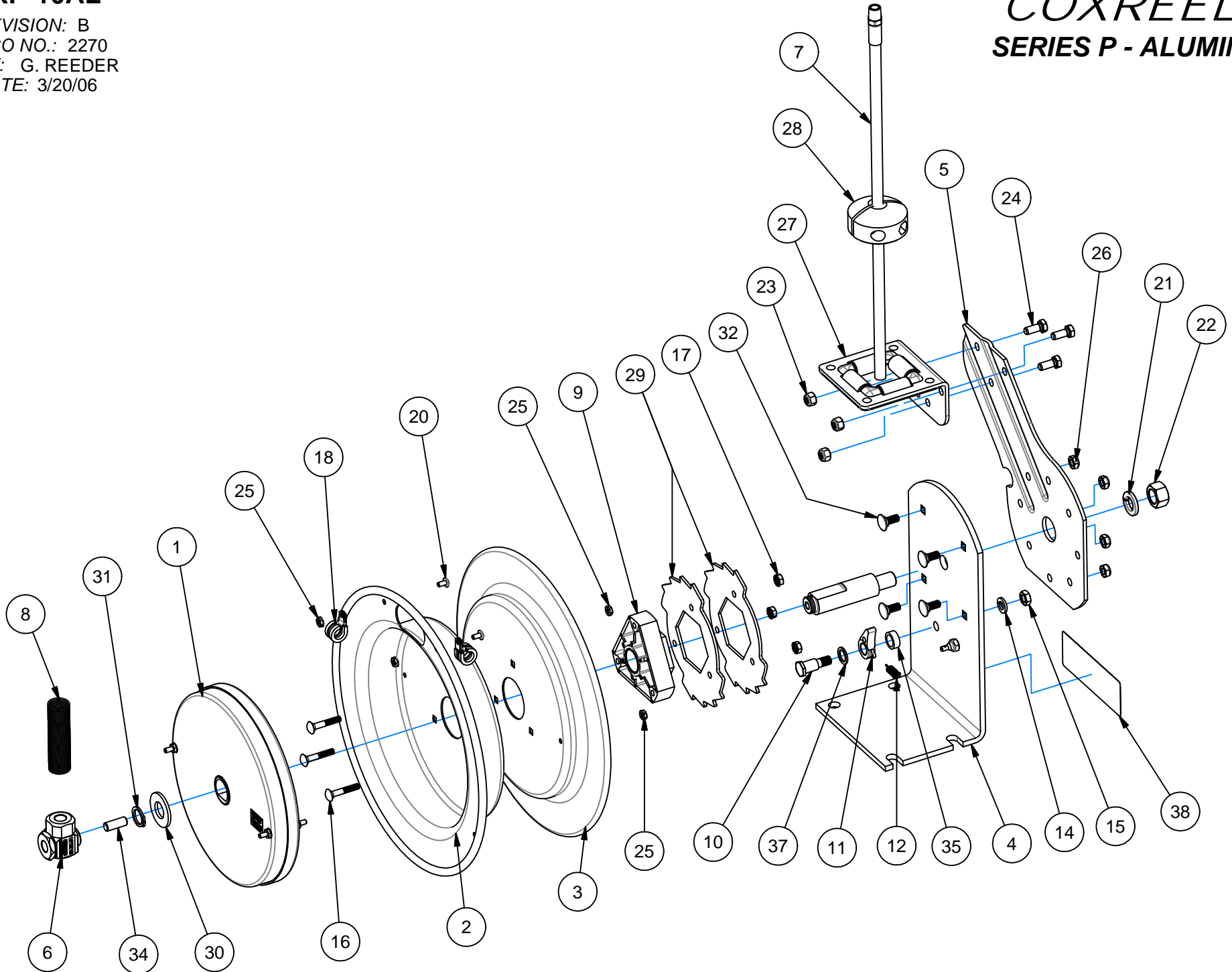

EXP-10AL

COMMON PARTS TO ALL SERIES P-ALUMINUM REELS

ITEM NO.	PART NO.	DESCRIPTION	QTY REQ'D
9	1776-3	ASSY., HUB BEARING	1
10	1620	BOLT, SHOULDER, 1/2"x1-1/2"	1
11	640-1-SS	CAM, LOCKING	1
12	274-1-SS	SPRING, DOG	1
14	437	WASHER, LOCK, 3/8"	1
15	184	NUT, JAM, 3/8-16	1
16	1953	CARRIAGE BOLT, 1/4-20 x 1.5	3
17	125	NUT, KEPS, 1/4-20	3
20	245	SCREW, TRUSS HD. 10-32x3/8"	2
21	438	WASHER, LOCK, 5/8"	1
22	3584	NUT, 5/8-11	1
23	111	NUT, LOCK, 5/16-18	3
24	312	BOLT, 5/16-18 X 3/4"	3

ITEM NO.	PART NO.	DESCRIPTION	QTY REQ'D
25	130	NUT, KEPS, 10-32	4
26	111-1	NUT, LOCK, 5/16-18, LOW PROF	4
29	1924-1-AL	LOCKING RING, ALUM.	2
30	1755-1	WASHER, SPACER	1
31	1753	RETAINING RING (5160-75)	1
32	10220-75	BOLT, CARRIAGE, 5/16-18x3/4"	4
34	10235-SS	STUD: 3/8-16 X 1" SS	1
35	6440-SS	WASHER, SPACER	1
37	6441-1	WASHER, SPACER	1
38	10925-5	LABEL	1

ITEM NUMBER

MODEL NO.	1	2	3	4	5	6	* 7	* 7	* 7	* 8	13	18 (2)	27	* 28
	SPRING	DRUM	DRUM	BASE	ARM	SWIVEL	HOSE (STD)	HOSE (-OG)	HOSE (-RH)	HOSE GRD	AXLE	CLAMP	ROLLER B.	BALL STOP
P-LP-125-AL	1959-3-AL	139-AL	140-AL	1954-AL	1732-1-AL	1969	5150-25	5121-25	3870-25	237-1	1956	2169	1728-2-AL	131
P-LP-150-AL	689-5-AL	1948-AL	1947-AL	1970-AL	1732-2-AL	1969	5150-50	5121-50	3870-50	237-1	1956	2169	1728-3-AL	131
P-LP-325-AL	1958-7-AL	139-AL	140-AL	1954-AL	1732-1-AL	1935	5153-25	5101-25	5045-25	237-1	1956	381	1728-2-AL	131-3
P-LP-350-AL	1961-7-AL	1948-AL	1947-AL	1970-AL	1732-2-AL	1935	5153-50	5101-50	5045-50	237-1	1956	381	1728-3-AL	131-3
P-LP-425-AL	689-2-AL	1948-AL	1947-AL	1970-AL	1732-2-AL	439	5154-25	5131-25	5066-25	389-1	1956	383	1728-3-AL	131-4
P-LP-430-AL	1961-5-AL	1948-AL	1947-AL	1970-AL	1732-2-AL	439	5154-30	5131-30	5066-30	389-1	1956	383	1728-3-AL	131-4

* ON "LESS HOSE" MODELS (P-LPL-) EXCLUDE ITEMS #7,#8, AND #28.

NOTE: MODELS SUPPLIED WITH "STANDARD" HOSE UNLESS SUFFIXED WITH "-OG" OR "-RH". USE HOSE NUMBERS AS NOTED ABOVE.

REEL ASSEMBLY REPORT R100 (LATCHOUT REMOVAL), R101 (LOCKING RING PLACEMENT), R112 (TIGHTENING AND TORQUING)

REVISION: B

ECO: 2270

DATE: 3/20/2006

NAME: G. REEDER